



HRT STRUCTURAL CUMMERBUND SIZING GUIDE

KNOW WHERE TO MEASURE:

WAIST: Run a tailor's tape around the fullest part of your waist just under the chest, and correspond your measurement to the chart below. For most accurate measurements be sure to dress as you would while wearing the cummerbund.

	S/M		M/L		L/XL	
	INCHES	CM	INCHES	CM	INCHES	CM
UPPER WAIST/MID TORSO	29-38"	74-97	35-47	89-119	41-56	104-142
MOLLE COLUMNS	3-7		5-10		7-13	

SLOT SIZING					
S/M		M/L		L/XL	
Slot 1	29-31"	Slot 1	35-37"	Slot 1	41-43"
Slot 2	31-33"	Slot 2	37-39"	Slot 2	43-45"
Slot 3	33-35"	Slot 3	39-41"	Slot 3	45-47"
Slot 4	35-38"	Slot 4	41-44"	Slot 4	47-50"
		Slot 5	44-47"	Slot 5	50-53"
		Slot 6	53-56"	Slot 6	53-56"

3" STRUCTURAL CUMMERBUND

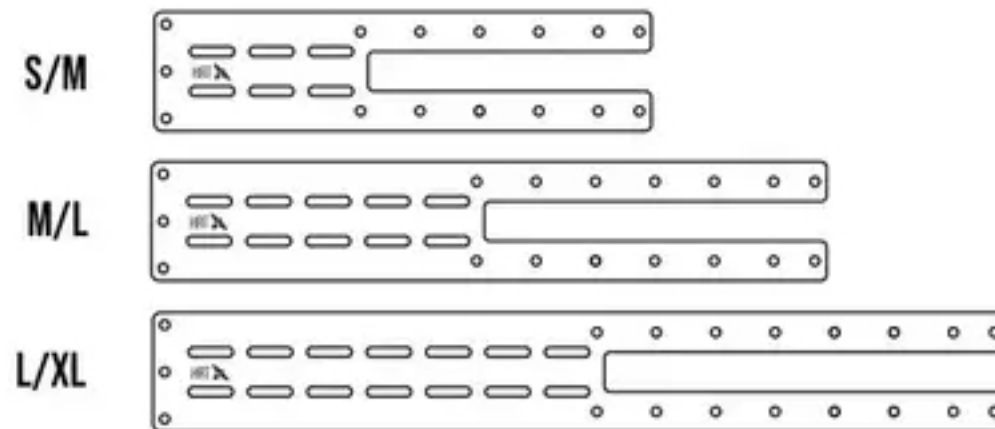

5" STRUCTURAL CUMMERBUND

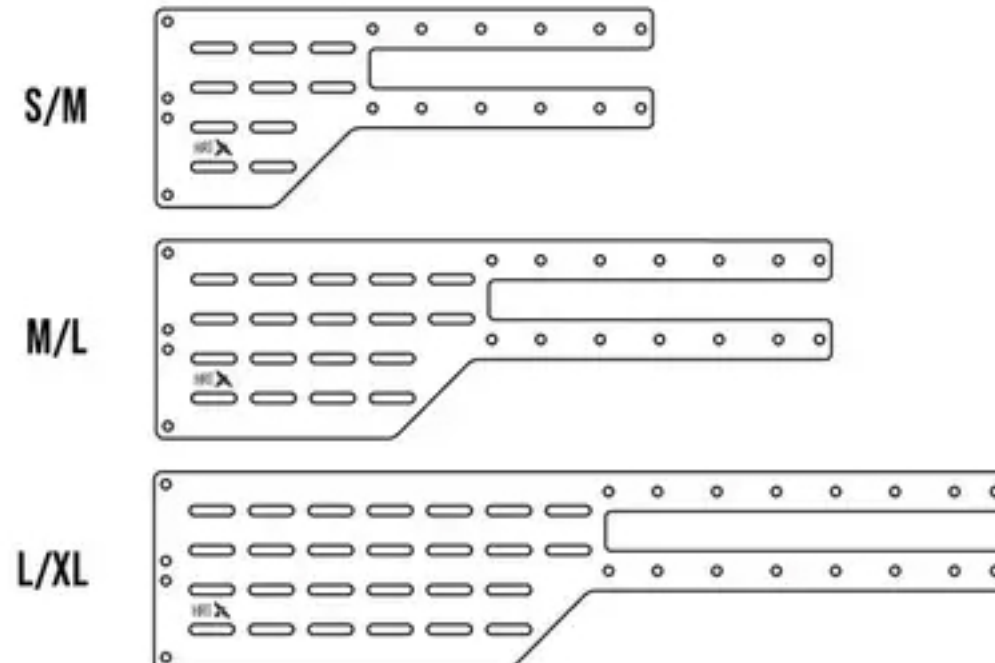

CUMMERBUND CONNECTOR
(INCLUDED WITH STRUCTURAL CUMMERBUNDS)

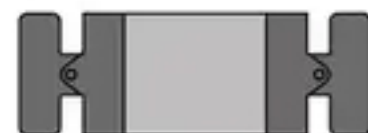

SIZING SLOTS
(LAST SLOT FROM END NOT USED)

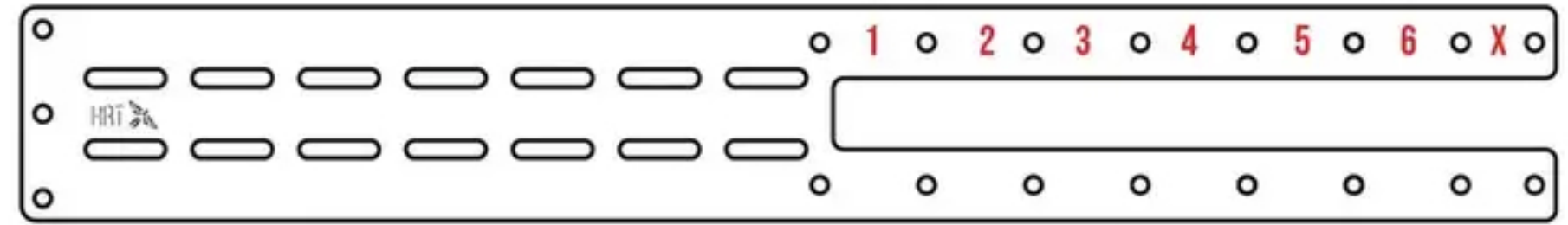

MOLLE COLUMNS
(LAST COLUMN FROM END NOT USED)

WHEN INSTALLING POUCHES, WEAVE MOLLE STRAPS OVER THE TOP IN BETWEEN THE CORE AND BACKING LAYER OF SQUADRON MATERIAL FIRST

ASSEMBLY GUIDE

1. REFERENCE THE SIZE GUIDE ENSURING YOU ARE MEASURING YOUR UPPER WAIST/MID-TORSO WHERE THE CUMMERBUND WOULD ALIGN. DO NOT USE YOUR PANTS SIZE.
2. OPEN THE PLATE FLAP OF THE REAR PLATE BAG. DO NOT INSERT PLATE YET.
3. WITH THE HRT LOGO FACING UP, SLIDE THE ARMS OF THE CUMMERBUND INTO THE SLOTS ON THE SIDE OF THE PLATE BAG. INSERT FAR ENOUGH TO GIVE YOURSELF WORKING ROOM WHEN INSTALLING THE CONNECTOR.
4. INSERT THE CUMMERBUND CONNECTOR INTO THE SLOT THAT ALIGNS WITH YOUR MEASUREMENT. THE CONNECTOR "T" SECTION SLIDES IN BETWEEN THE SQUADRON FABRIC AND THE RIGID CURV CORE ON EACH OF THE CUMMERBUND ARMS.
5. REPEAT STEPS 3 & 4 WITH THE OTHER SECTION OF CUMMERBUND. WE RECOMMEND LAYERING THE CUMMERBUND AND CONNECTOR SO YOU HAVE A SECTION OF CUMMERBUND ON TOP AND BOTTOM WITH THE CONNECTOR SANDWICHED IN BETWEEN.
6. INSERT YOUR PLATE INTO THE PLATE BAG ENSURING IT IS UNDERNEATH THE CUMMERBUND ASSEMBLY.
7. CENTER THE CUMMERBUND ASSEMBLY.
8. FOLD THE PLATE BAG FLAP INTO THE BOTTOM OF THE PLATE BAG ENSURING IT IS ON TOP OF THE CUMMERBUND ASSEMBLY INSIDE THE PLATE BAG. IT WILL VELCRO IN PLACE.
9. VELCRO THE QUICK RELEASE PANELS TO THE FRONT PLATE BAG.
10. CONNECT ONE SIDE OF THE CUMMERBUND, DON THE CARRIER THEN MAKE ANY NECESSARY SIZES ADJUSTMENTS.

